



State of Rhode Island  
**Coastal Resources Management Council**  
Oliver H. Stedman Government Center  
4808 Tower Hill Road, Suite 3  
Wakefield, RI 02879-1900

(401) 783-3370  
Fax (401) 783-2069

### **PUBLIC NOTICE**

File Number: 2024-07-008 Date: July 31, 2024

This office has under consideration the application of:

Curtis Doberstein, Trustee  
123 Leonard Drive  
Tiverton, RI 02878

for a State of Rhode Island Assent to construct and maintain: a new 16,000 pound boat lift and 11' x 4' fixed pier extension off an existing residential boating facility.

Project Location:	123 Leonard Drive
City/Town:	Tiverton
Plat/Lot:	Plat 402, lot 118
Waterway:	Sakonnet River

Plans of the proposed work can be requested at [Cstaff1@crmc.ri.gov](mailto:Cstaff1@crmc.ri.gov).

In accordance with the Administrative Procedures Act (Chapter 42-35 of the Rhode Island General Laws) you may request a hearing on this matter.

You are advised that if you have good reason to enter protests against the proposed work it is your privilege to do so. It is expected that objectors will review the application and plans thoroughly, visit site of proposed work if necessary, to familiarize themselves with the conditions and cite what law or laws, if any, would in their opinion be violated by the work proposed.

If you desire to protest, you must attend the scheduled hearing and give sworn testimony. A notice of the time and place of such hearing will be furnished you as soon as possible after receipt of your request for hearing. If you desire to request a hearing, to receive consideration, it should be in writing (**with your correct mailing address, e-mail address and valid contact number**) and be received at this office on or before August 31, 2024.

Please email your comments/hearing requests to: [cstaff1@crmc.ri.gov](mailto:cstaff1@crmc.ri.gov); or mail via USPS to: Coastal Resources Management Council; O. S. Government Center, 4808 Tower Hill Road, Rm 116; Wakefield, RI 02879.

/lat



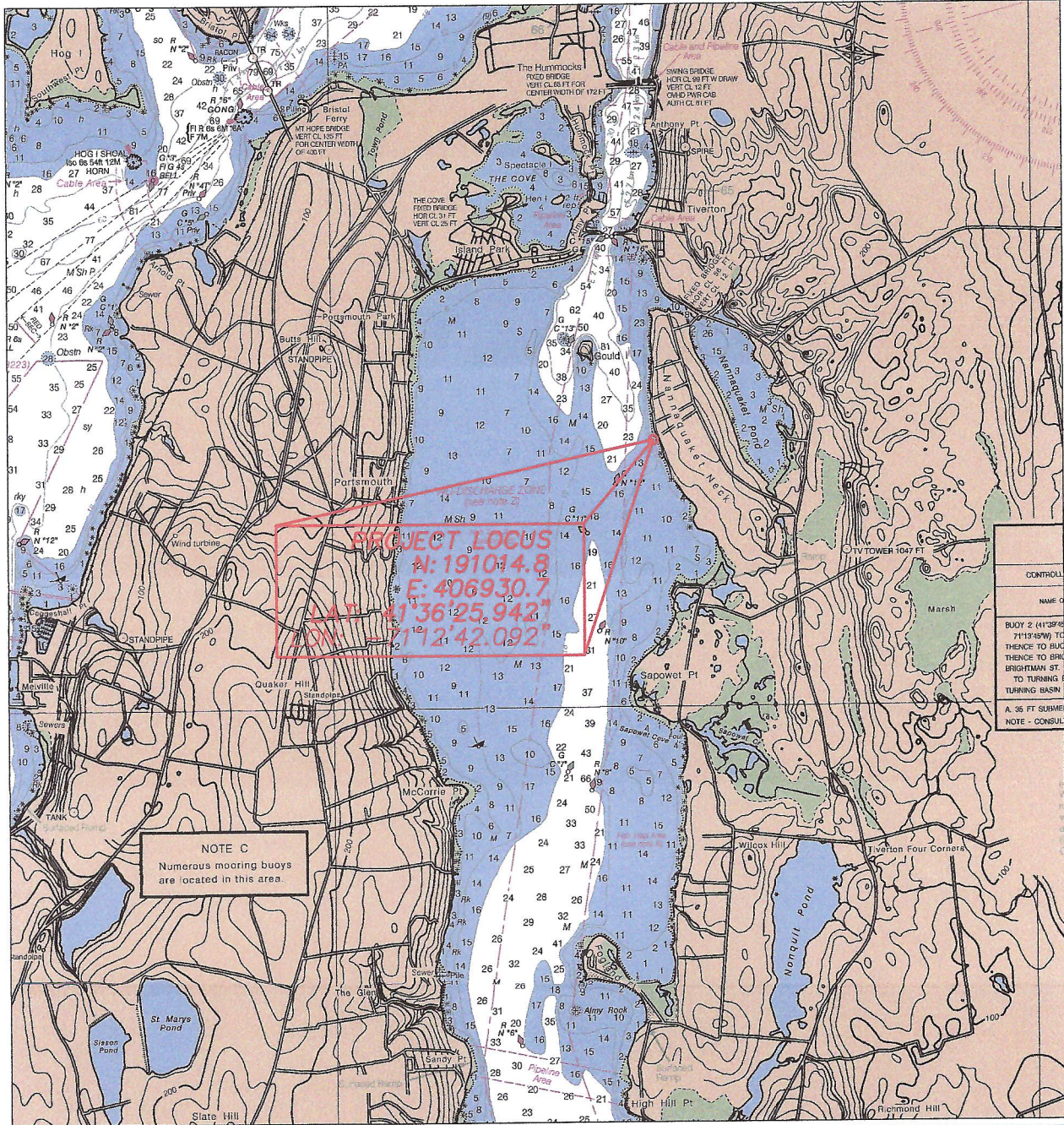

**PROJECT LOCUS**  
 N: 191014.8  
 E: 406930.7  
 LAT: 41°36'25.942"  
 LON: -71°12'42.092"

**NOTE C**  
 Numerous mooring buoys  
 are located in this area.

CONTROLL
NAME G
BUOY 2 (41°39'48"
71°19'45"W) TO
THENCE TO BUC
THENCE TO BRG
BRIGHTMAN ST.
TO TURNING
TURNING BASIN
A. 35 FT SURGE
NOTE - CONSULT

**PROJECT LOCUS**  
 1"=5280' (NOAA 13221)



**WARREN HALL**  
**CIVIL ENGINEER**

PROPOSED BOAT LIFT FOR:  
 CURTIS DOBERSTEIN, TRUSTEE  
 123 LEONARD DRIVE  
 AP 402, LOT 118  
 TIVERTON, RI 02878  
 BY: WARREN HALL, CIVIL ENGINEER  
 JUNE 11, 2024 SHEET 1 OF 4

**WARREN F HALL**

No. 5114  
 REGISTERED  
 PROFESSIONAL ENGINEER  
 CIVIL

**RECEIVED**  
**6/27/2024**  
 COASTAL RESOURCES  
 MANAGEMENT COUNCIL



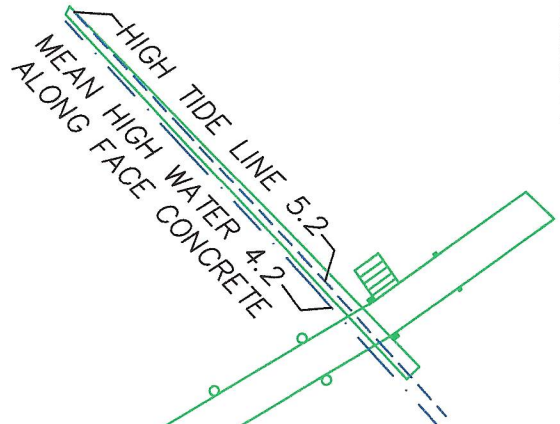
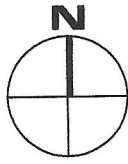

SAKONNET RIVER  
CRMC TYPE 2 WATER

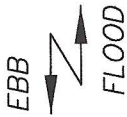

100' TO PLE

67' TO FLOAT  
PILES

M.L.W. 0.00

FIXED PIER DECK EL=10.4

REF CRMC 1998-11-017

WATER DEPTH  
AT REGULAR  
LOW TIDE

PROPERTY LINE EXTENSION (PLE)

PLAN VIEW  
1"=20'

WARREN HALL  
CIVIL ENGINEER

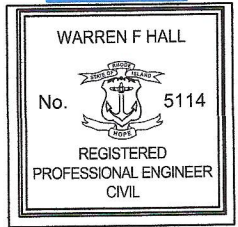

(A) 16,000 POUND BOAT LIFT  
4 POST 4 MOTOR  
LIFT

(B) 4'x11' DECK SET 3.5'±  
OFF EXISTING PIER, SEE  
SHEET 3, WITH 18" BUMP OUT

(C) 2 NEW TIE OFF PILES

PROPOSED BOAT LIFT FOR:  
CURTIS DOBERSTEIN, TRUSTEE  
123 LEONARD DRIVE  
TIVERTON, RI 02878  
BY: WARREN HALL, CIVIL ENGINEER  
JUNE 11, 2024 SHEET 2 OF 4



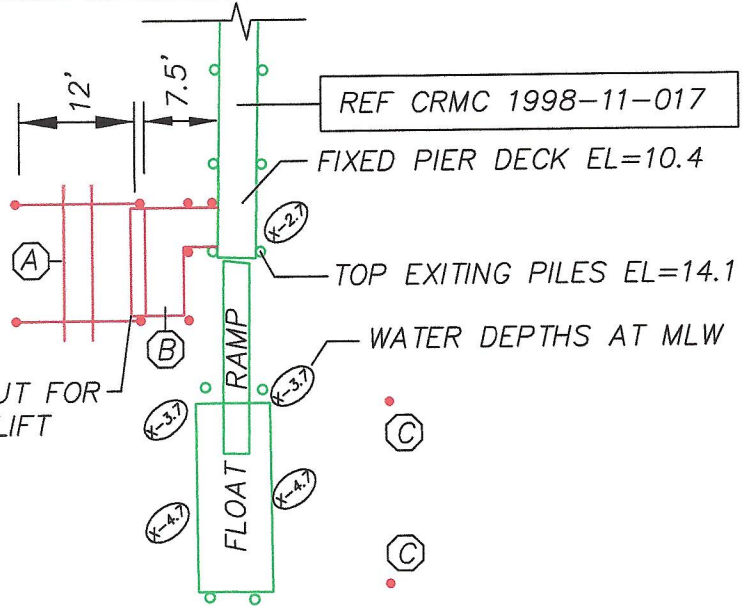
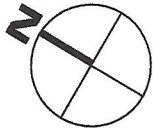

PLAN VIEW  
1"=20'

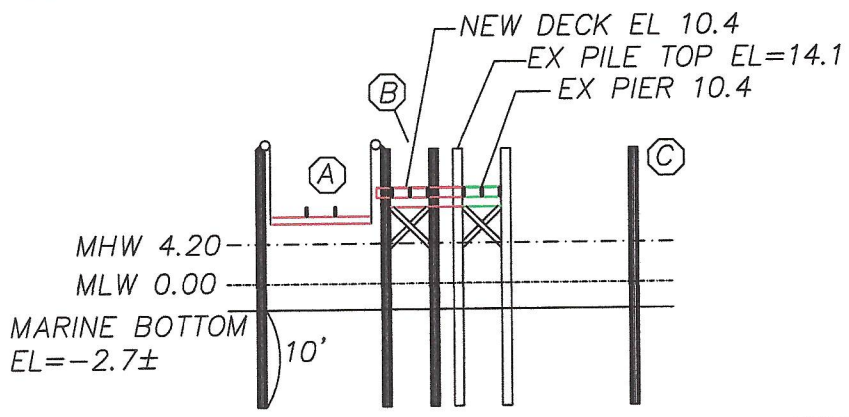

PROFILE VIEW  
1"=20'

- (A) 16,000 POUND BOAT LIFT  
4 POST 4 MOTOR LIFT
- (B) 4'x11' DECK SET 3.5'±  
OFF EXISTING PIER, SEE  
SHEET 3, WITH 18" BUMP OUT
- (C) 2 NEW TIE OFF PILES

NOTES:

- 1) PROVIDE STOPS TO PREVENT GUNWALE OF VESSEL FROM BEING ANY HIGHER THAN FIXED DECK ELEVATION OF 10.4
- 2) TOP OF NEW PILES TO MATCH ELEVATION OF EXISTING FIXED PIER PILES OF 14.1
- 3) LIFT MOTOR MAY BE ATTACHED TO TOP OF NEW PILES BUT NO HIGHER THAN 5' ABOVE FIXED DECK ELEVATION OF 10.4

WARREN HALL  
CIVIL ENGINEER

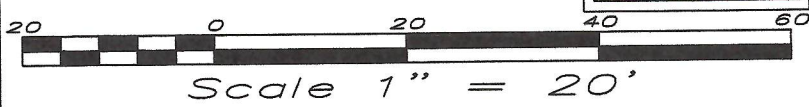
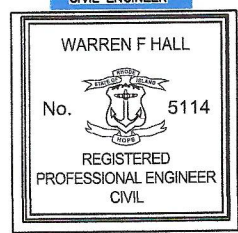

PROPOSED BOAT LIFT FOR:  
CURTIS DOBERSTEIN, TRUSTEE  
123 LEONARD DRIVE  
AP 402, LOT 118  
TIVERTON, RI 02878  
BY: WARREN HALL, CIVIL ENGINEER  
JUNE 11, 2024 SHEET 3 OF 4





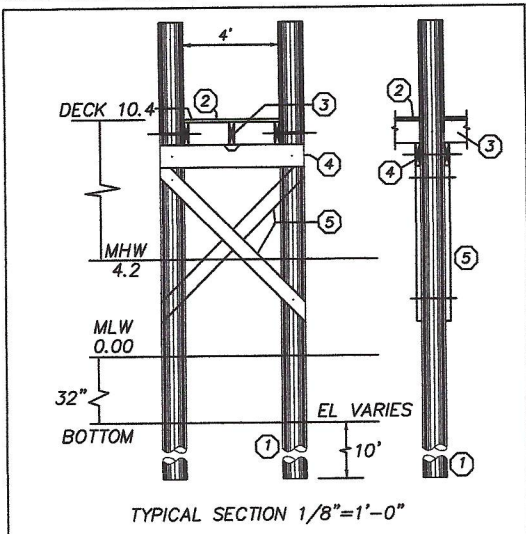

- ① 10" TIP CCA TREATED WOOD PILES TREAT TO 2.5 PCF (1.0 ALLOWED WITH OWNER CONSENT)
- ② 2x6 DECKING ACQ TREATED TO .6 PCF FASTEN TO STRINGERS WITH 3 @ 3-1/2" NO. 10 316 STAINLESS STEEL SCREWS
- ③ 3x12 STRINGER, ACQ TREATED THRU BOLT AT PILE FASTEN MIDDLE STRINGER WITH SIMPSON H-1 HURRICANE ANCHOR
- ④ 2-3x12 CAP BEAM, ACQ TREATED TO .6 PCF
- ⑤ 3x10 CROSS BRACE, ACQ TREATED TO 2.5 PCF

**GENERAL NOTES:**

- 1) ALL BOLTS, CONNECTORS, WASHERS, NAILS, ECT SHALL BE HOT DIPPED GALVANIZED
- 2) CONTRACTOR SHALL ADHERE TO ALL OSHA RULES AND REGULATIONS THROUGHOUT ALL PHASES OF CONSTRUCTION
- 3) CONTRACTOR SHALL BE AWARE THAT THE STRATA INTO WHICH THESE PILES ARE TO BE DRIVEN MAY REQUIRE DRILLING TO ENSURE A MINIMUM 10' PENETRATION BELOW EXISTING GRADE

### GATORVATOR 4 POST, 4 MOTOR LIFT

**STRUCTURAL ENGINEERING REVIEW**

THIS PLAN SET FOR THE CONSTRUCTION HAS BEEN REVIEWED AND APPROVED FOR THE DESIGN AND CONSTRUCTION OF THE LIFT. THE CONTRACTOR SHALL BE RESPONSIBLE FOR THE DESIGN AND CONSTRUCTION OF THE LIFT. THE CONTRACTOR SHALL BE RESPONSIBLE FOR THE DESIGN AND CONSTRUCTION OF THE LIFT. THE CONTRACTOR SHALL BE RESPONSIBLE FOR THE DESIGN AND CONSTRUCTION OF THE LIFT.

*Warren F. Hall*

Professional Engineer  
No. 5114  
State of Rhode Island  
Civil Engineering

**NOTE:** BOLTS SHALL NOT BE STOLEN OR LIFT DURING HIGH WIND EVENTS.

**NOTES:** IN GENERAL, PILING PENETRATION TO BE 10' INTO THE SAND BOTTOM OR 2' INTO THE ROCK STRATA, SURF-SURFACE CONDITIONS CAN VARY GREATLY, THE CONTRACTOR SHALL VERIFY ALL PILE CAPACITIES. ALL WOOD PILING TO BE 2.5 CCA TREATED.

LIFT CAPACITY LBS.	PILE CAPACITY LBS.	GROUND WINDERS IN.	DRIVE SHAFT IN.	DRIVE PILE 3,000 FT	DRIVE PILE 3,000 FT	LIFTING CABLE NO. OF CABLES	LIFT PER MIN IN.	GUIDE POST HEIGHT IN.	BOAT BUNK IN.	CRDL. SW. 1" DIA. SIZE IN.	Recomm. Min Piling Size IN.
7,000										2 x 8 x 144	8'9"
10,000		3 x x 12"				(4) .375 ø	15'/MIN.	80"		3 x 10 x 125	10'9"
14,000	30' S.S. 2 PILE	3 x x 12"	1.800 O.D. S. IN. DRIV. STEEL PILE			(4) .375 ø	15'/MIN.	120"		4 x 10 192	12'9"
16,000		3.5 x x 12"				(4) .375 ø	15'/MIN.			4 x 12 200	
20,000		3.5 x x 16"	2.000 O.D. S. IN. DRIV. STEEL PILE			(4) .375 ø	15'/MIN.			4 x 12 200	
24,000	45' S.S. 3 PILE	3.5 x x 16"				(4) .375 ø	15'/MIN.			4 x 12 200	
30,000											

Golden Manufacturing, Inc. 17811 East Street, N. Fort Myers Florida 33917 Pub 0312  
PAGE 1 OF 2

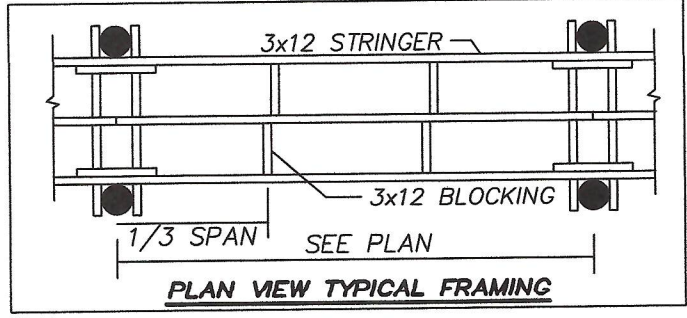

**PILE DRIVING NOTE:**

A "soft start" is required to allow animals an opportunity to leave the project vicinity before sound pressure levels increase. In addition to using a soft start at the beginning of the work day for pile driving, one must also be used at any time following cessation of pile driving for a period of 30 minutes or longer. For impact pile driving: pile driving will commence with an initial set of three strikes by the hammer at 40% energy, followed by a one minute wait period, then two subsequent 3-strike sets at 40% energy, with one minute waiting periods, before initiating continuous impact driving.

**WARREN HALL**  
**CIVIL ENGINEER**

PROPOSED BOAT LIFT FOR:  
CURTIS DOBERSTEIN, TRUSTEE  
123 LEONARD DRIVE  
AP 402, LOT 118  
TIVERTON, RI 02878  
BY: WARREN HALL, CIVIL ENGINEER  
JUNE 11, 2024 SHEET 4 OF 4

WARREN F HALL

No. 5114

REGISTERED  
PROFESSIONAL ENGINEER  
CIVIL

**RECEIVED**  
**6/27/2024**  
**COASTAL RESOURCES  
MANAGEMENT COUNCIL**